

East and Mason - Sound Side Residences

Wilmington, NC | Priced: From the \$1 Million+

New Custom Homes Available

HOMESITE 151

4205 Watersail Drive
Wilmington, NC 28409

5 Bed | 4 Bath | 1 Half Bath

3354 Square Feet

2 Car Garage

MLS: 100492204

Built by: SCHMIDT CUSTOM BUILDERS INC

\$1,208,000 / AVAILABLE

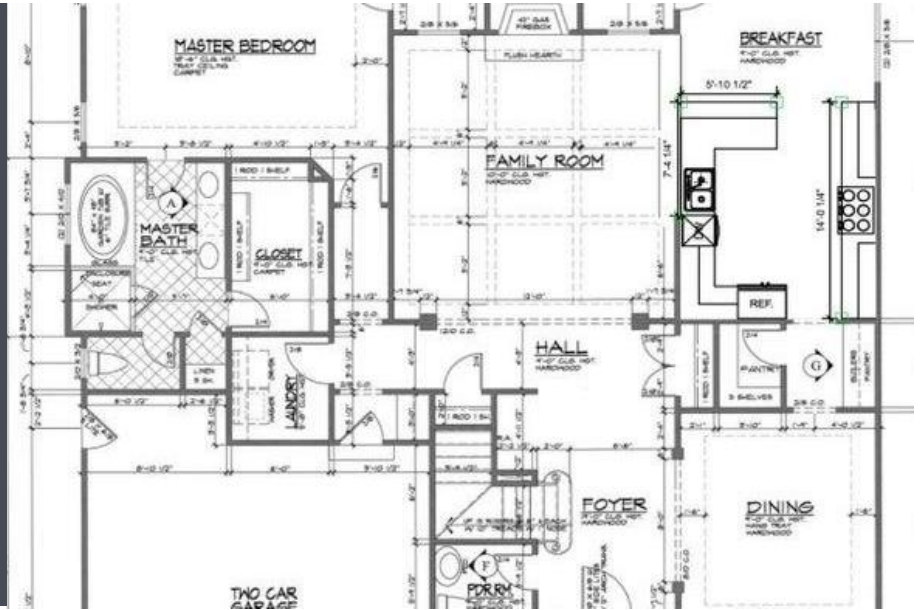

HOME DESCRIPTION

Introducing Masonboro Harmony by Schmidt Custom Builders. A masterfully crafted home designed with natural materials and elements that embrace a seamless connection to nature. Masonboro Harmony stays true to the traditional character of Craftsman architecture, enhanced with a modern flair--featuring brick detailing, overhanging eaves, picture-framed wainscoting, and V-groove ceilings. The harmonious blend of earthy tones and rich textures, paired with a soothing color palette, creates the perfect sanctuary to call home. Step onto the spacious front porch and into a thoughtfully designed open-concept floor plan, where the foyer leads to a stunning dining area and expansive main living space. The must-see kitchen is a true showpiece, blending both functionality and style. The first-floor primary suite is an elegant retreat, complete with a light-filled sitting area, spa-like bath with a walk-in shower, soaking tub, and an oversized walk-in closet. Upstairs, you'll find a versatile loft, four additional bedrooms, a spacious bonus room, and convenient walk-in storage. Located in the sought-after East and Mason community, residents enjoy paved sidewalks and trails, a resort-style pool, and a clubhouse with scenic pond views. Don't miss your opportunity to own this exceptional home! Contact us today to learn more about making Schmidt Custom Builders Masonboro Harmony home yours.

CONTACT COMMUNITY

Sales Associate: Kathleen Postel & Aaron Favolise
(910) 994-1482 | Eastandmason@fmbnewhomes.com
eastandmason.com

Prices, promotions, specifications and community information are subject to change without notice. 09/2025

