

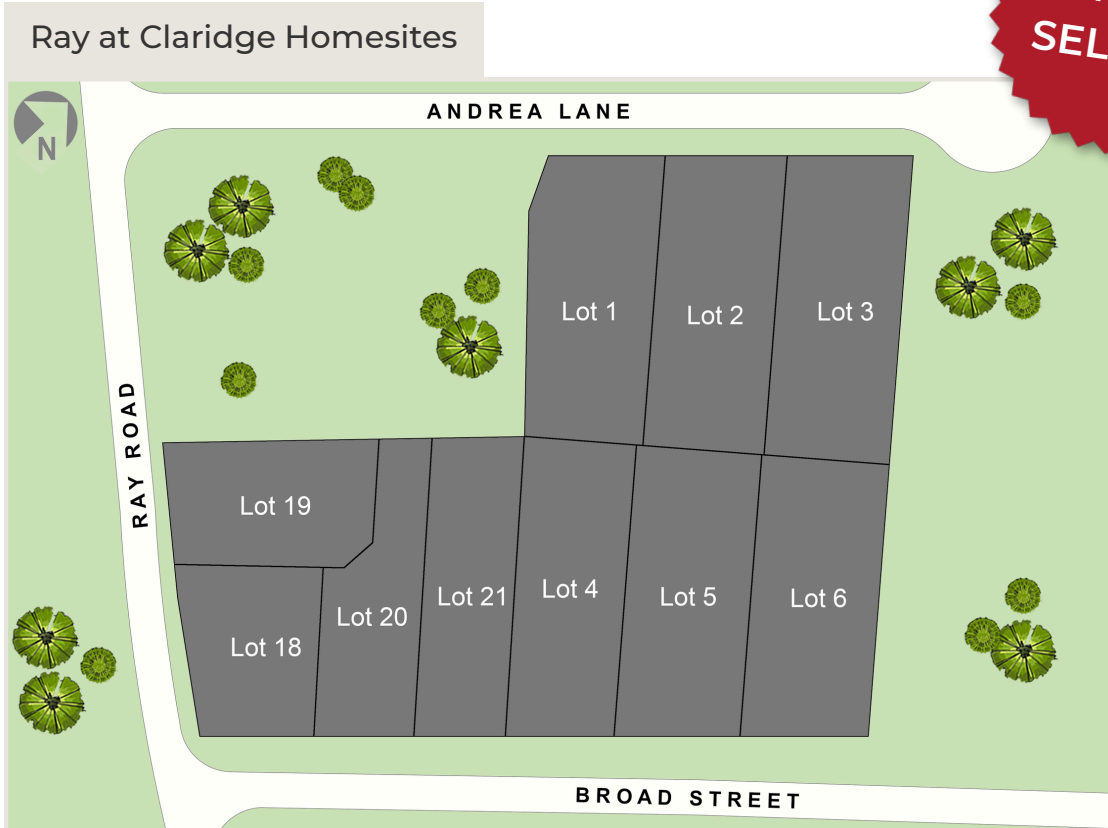

# STONEHENGE Community Plan



Robuck Homes returns to Raleigh with an intimate collection homesites from the upper \$900s along Ray Road. A limited number of new home opportunities await.

**Michael Bishop**

Onsite Sales Associate

919-909-2860 | [Stonehenge@FMBnewhomes.com](mailto:Stonehenge@FMBnewhomes.com)



[RobuckHomesonRay.com](http://RobuckHomesonRay.com)



Site plan and specifications are an artist's representation and are subject to change without notice. 4/2026 🏠