



Modern Farmhouse



Craftsman

WYNDWATER

BY ROBUCK HOMES

RobuckHomes.com

*All plans, details, and renderings are approximate and subject to change.  
Illustrations may not represent finished details. 12/23*





Sliding Glass Door at Family



Screened Porch  
19'-8" x 9'-0"  
Optional Screened  
Porch in lieu of Patio

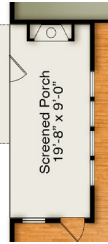

Screened Porch  
19'-8" x 9'-0"  
Optional Screened  
Porch with Fireplace



Modern Farmhouse Elevation

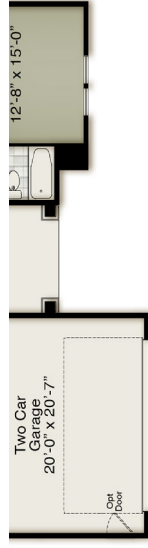

Craftsman Elevation

## First Floor



Primary Bath with  
Freestanding Tub



Dual Vanity

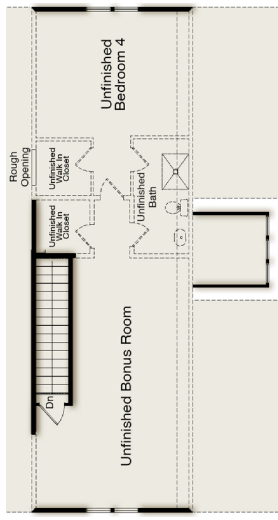

Unfinished Walk-Up

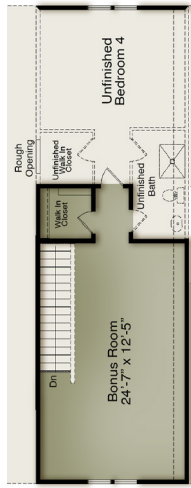

Finished Bonus & Unfinished Bed/Bath

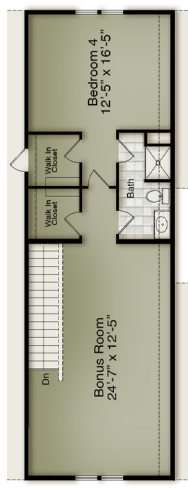

Finished Bonus & Finished Bedroom 4  
with Bathroom

## Second Floor



RobuckHomes.com

All plans, details, and renderings are approximate and subject to change. Illustrations may not represent finished details. 12.23

