



CHATHAM WALK

THE BRADFORD

1 BEDROOM & OFFICE/STUDY
1 1/2 BATHROOMS



RESIDENCE FEATURES:

- Open Modern Floorplan
- Pre-Finished Hardwood Flooring
- Large Island with Seating Space
- Premium, Soft Close Cabinetry
- Quartz Counters & Subway Tile Backsplash
- Elegantly Proportioned Windows
- Walk-in Closets with Wood Shelving
- Private Balcony

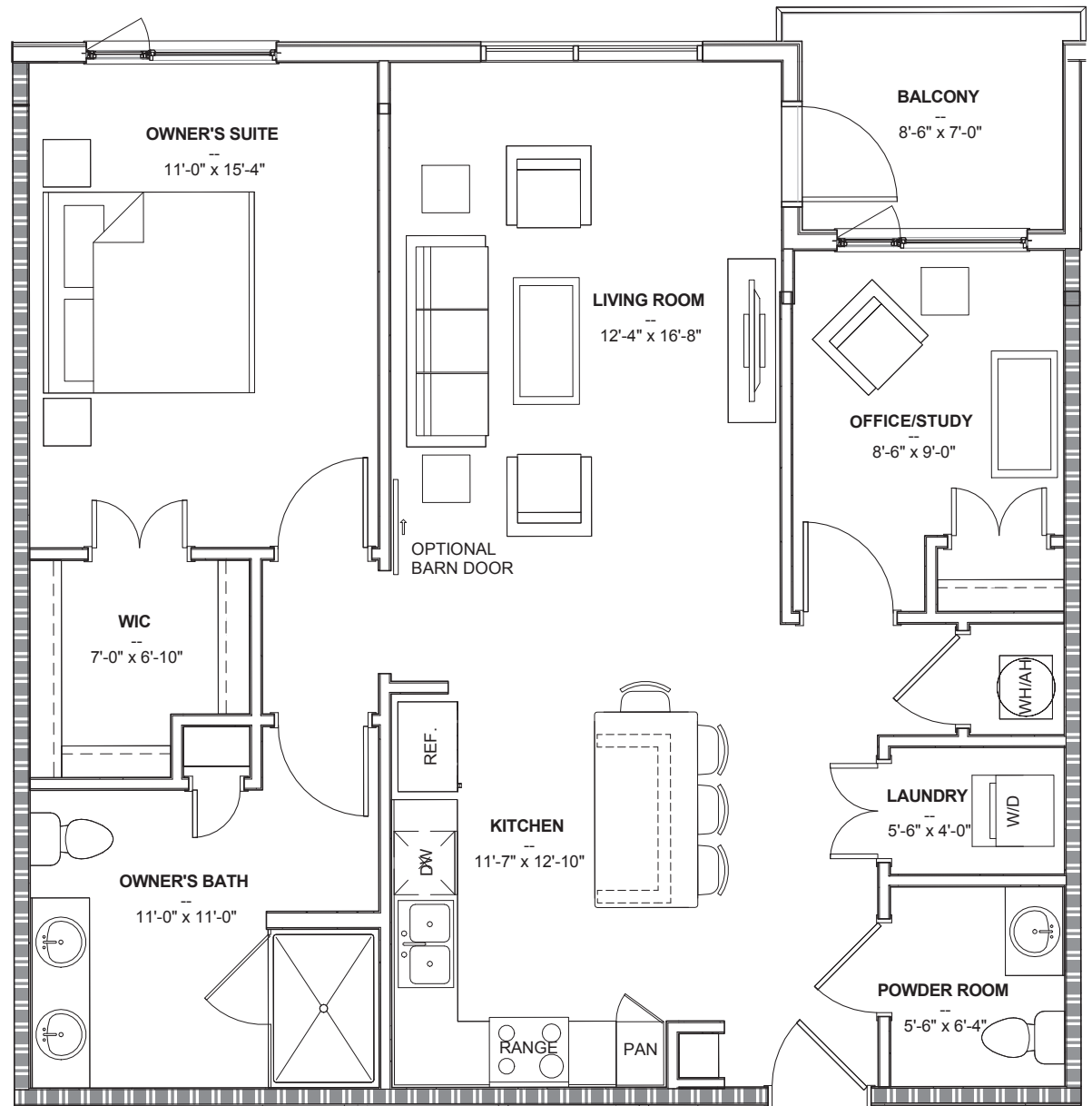

SALES OFFICE:

215 E Chatham Street | Suite 115 | Cary, NC 27511

919.926.5527