



THE WINSTON



CRAFTSMAN KS ELEVATION

SQUARE FEET: APPROX. 2,185

BEDROOMS: 3 TO 4

BATHROOMS: 2.5



Single Door Garage



McKee Homes
101 Hay Street • Fayetteville, NC 28301
Sales: 910-672-7296 • Main Office: 910-475-7100
sales@mckeehomesnc.com • www.McKeeHomesNC.com



These plans are for marketing purposes only. Square footage and dimensions may vary and are not guaranteed. Specific features and options vary from home to home and from one community to another. We reserve the right to substitute equipment, materials and appliances with items of equal or higher value at our own discretion. Floor plans are the copyright protected property of McKee Homes. © 2014 McKee Homes. All rights reserved.

FIRST FLOOR
Approx. 1,490 Sq. Ft.



SECOND FLOOR
Approx. 695 Sq. Ft.

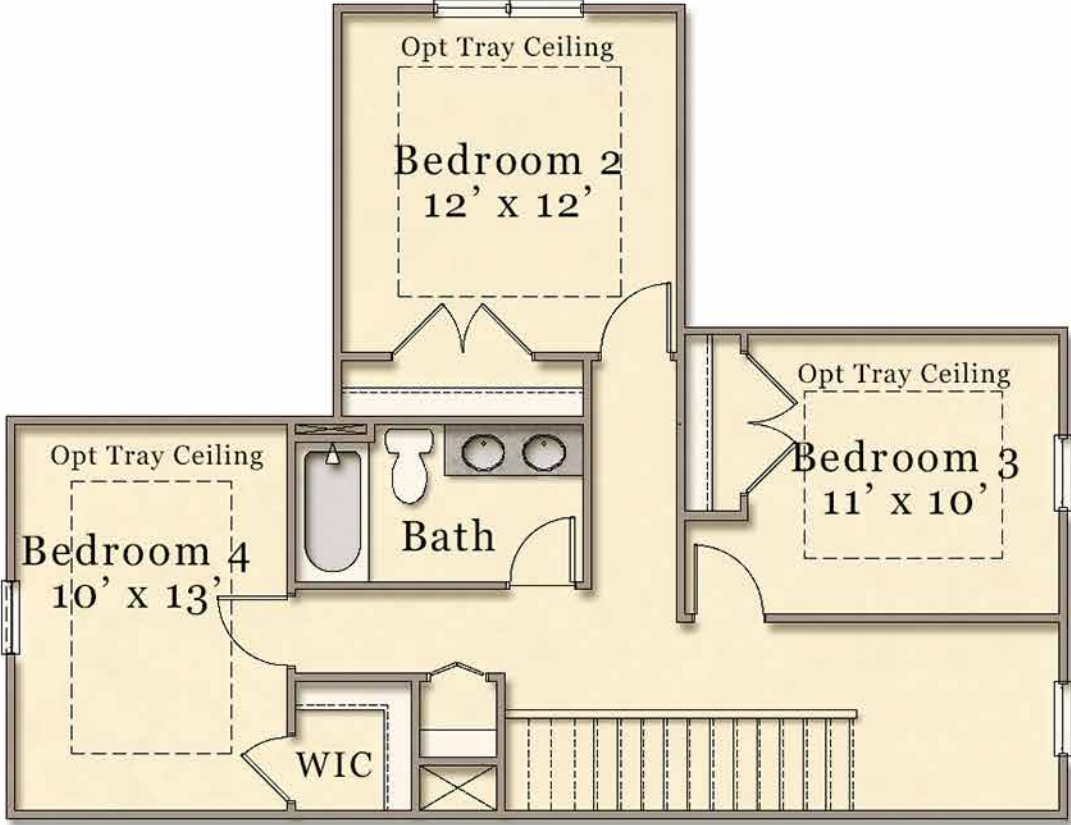

SECOND FLOOR
Optional Open Loft
Approx. 695 Sq. Ft.

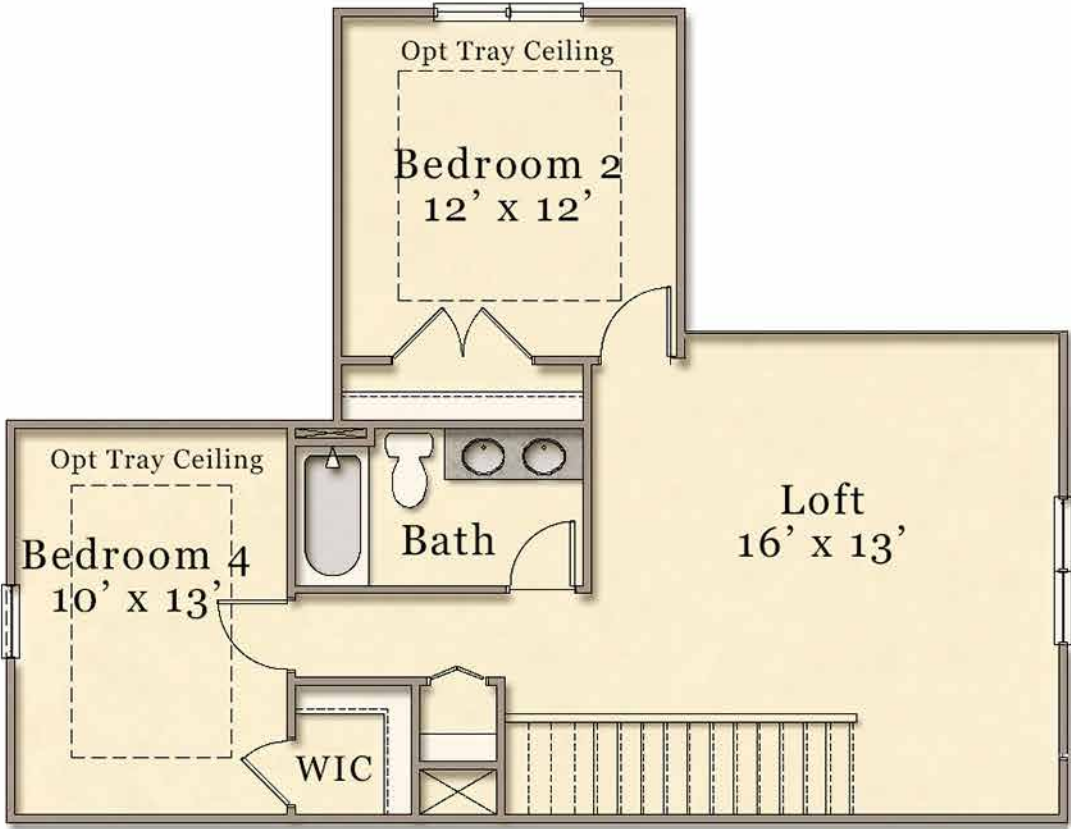

OPTIONAL SINGLE DOOR GARAGE

